

Gigabit Single-Port PoE Injector



Electra-P2-30W



Is a single port PoE Injector. It provides 55Vdc, 0.55A power for remote PDs over 2-pairs. It supports both 10/100 Base-T and Gigabit device. It works for 30W PoE PDs, such as wireless APs, Network cameras, IP Phones and other high power Ethernet terminals. It fully complies to IEEE802.3af/at PoE standard.

ELECTRA-P2-30W is designed for indoor use. It works with input voltage of 100-240Vac. It has detection chip inside, which will detect and classify PD before powering it. It will not apply power until a standard-compliant PD is detected. The effective distance is 100 meters over Cat5e/Cat6 cables.

The ELECTRA-P2-30W Mid-spans eliminate the need for external power supply and its associated AC/DC power cabling, providing a compact, affordable, safe and reliable power solution over existing Ethernet infrastructure.



Application Architecture

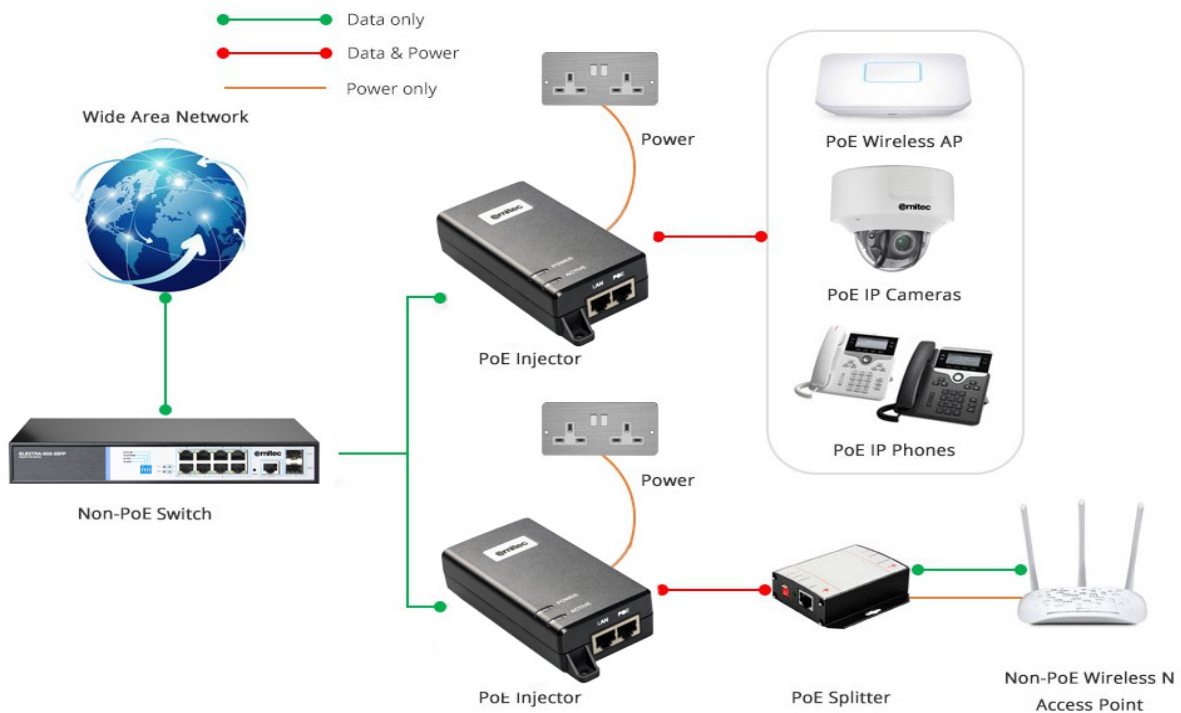

Standard

- IEEE802.3 10Base-T Ethernet
- IEEE802.3u 100Base-Tx Fast Ethernet
- IEEE802.3ab 1000Base-T Gigabit Ethernet
- Full compliant with IEEE802.3af/at
- RoHS Compliance
- WEEE Compliance/infrastructure.

Input & Output

- Input :100-240Vac 1.0A 50/60Hz
- Output: 55Vdc 550mA
- Power Pins: 4/5(+), 7/8(-)
- Data Speed: 10/100/1000Mbps

Working Environment

- Operating Temperature: 0 to 40
- Operating Humidity: 20% to 80%, non-condensation
- Storage Temperature: -20 to 70
- Storage Humidity: 10% to 90%, non-condensation
- Operating Altitude: up to 2000meters

AC Surge Protection

- 1.0KV (5P/5N)
- L-N 1.2/50 (8/20) Tr/Th us
- 2.0KV (5P/5N)
- L-PE 1.2/50 (8/20) Tr/Th us
- N -PE

Mechanical Characteristics

- Case: Plastic
- Color: Black
- Mounting: Wall-mounted
- IP Rated: IP40
- Size: 140mm X 63mm X 33mm
- Weight: 205g

Item Number & Packing

- **ELECTRA-P2-30W**
- 1 X POWER CORD, CEE 7/7 TO IEC C5
- 1 X MANUAL

Safety Approvals

- CE
- FCC

EMI

- FCC CFR47 Part 15, EN55024, EN55032

EMS

- IEC61000-4-2(ESD) $\pm 6kV$ (contact), $\pm 8kV$ (air)
- IEC61000-4-3(RS) 10V/m(80MHz~2GHz)
- IEC61000-4-4(EFT) Power Port: $\pm 2kV$; Data Port: $\pm 1kV$
- IEC61000-4-5(Surge) Power Port: $\pm 1kV/DM$, $\pm 2kV/CM$
- IEC61000-4-6(CS) 10V(150kHz~80MHz)

Immunity

- IEC60068-2-6(Vibration)
- IEC60068-2-27(Impact)
- IEC60068-2-32(Free Fall)

LED

- Power Indicator : Green
- PoE Load Indicator : Green

